

IT.	DESCRIPTION	MATERIAL
1	BODY	ASTM A216 GR. WCB
2	SEAT RING	ASTM A105 + STELLITE
3	DISC	ASTM A105 + 13 Cr.
4	DISC NUT	ASTM A182 F304
5	HINGE	ASTM A216 GR. WCB
6	HINGE PIN	ASTM A182 GR. F6a
7	YOKE	ASTM A216 GR. WCB
8	COVER	ASTM A216 GR. WCB
9	EYEBOLT	ASTM A105
10	GASKET	316 + GRAPHITE
11	COVER BOLT	ASTM A193 GR. B7
12	COVER NUT	ASTM A194 GR. 2H
13	HINGE BOLT	ASTM A182 F304

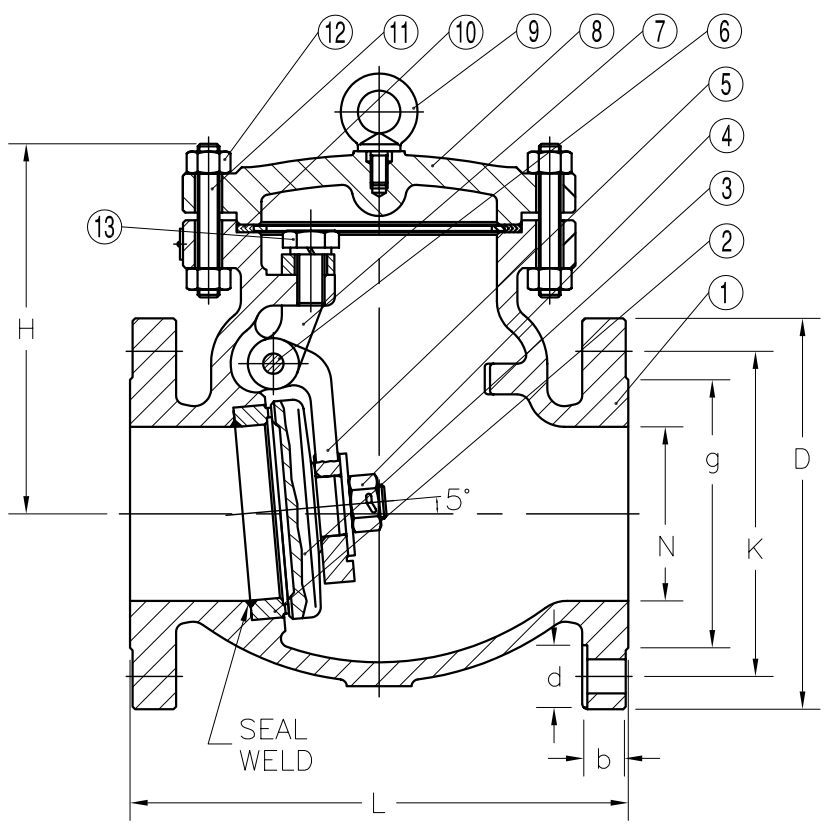

SIZE	L	N	H	End Flange					
				D	Bolt Hole			g	b
					K	No.	d		
8"	19.5	8	14.37	13.5	11.75	8	0.88	10.75	1.06
200 MM	495	203	365	342	298.5	8	23	270	29.0

STANDARDS	
Design	BS 1868, API 6D
Pressure - Temp. Rating	ANSI B16.34
Face to Face Dimension	ANSI B16.10
Connection	ANSI B16.5
Test & Inspection	API 598

CUSTOMER:
P.O. NUMBER:
TAG NUMBER:
JOB NUMBER:
BB/TRIM: A216 GR. WCB / 13 CR.



**BONNEY FORGE**

U.S. ROUTE 522 SOUTH  
P.O. BOX 330  
MOUNT UNION, PA 17066

**SWING CHECK VALVE  
CAST STEEL BOLTED BONNET  
ANSI CLASS 150 SIZE 8"**

REV	DESCRIPTION	DATE	BY	DR.	GW	DATE	6-28-00	DRAWING NO.	1-61-RF	REV.	0
	REVISIONS			APPD.	BG	SCALE	NONE				