

C Series Carbon Steel Bar Stock Ball Valves

CSSDR-1

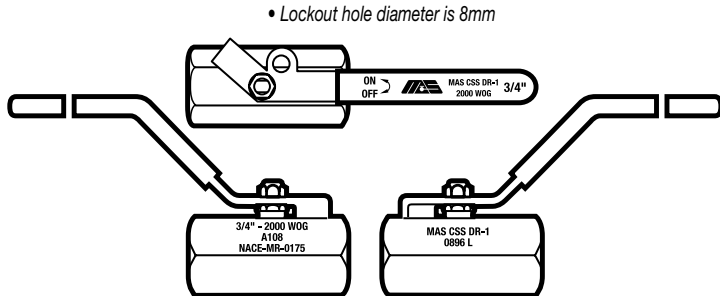

- Reduced port
- NPT ends to ANSI B1.20.1
- One piece body
- Blowout-proof stem
- 2000 p.s.i., W.O.G.
- Comply to NACE MR-01-75-2002 & MR-01-03 Hardness requirements

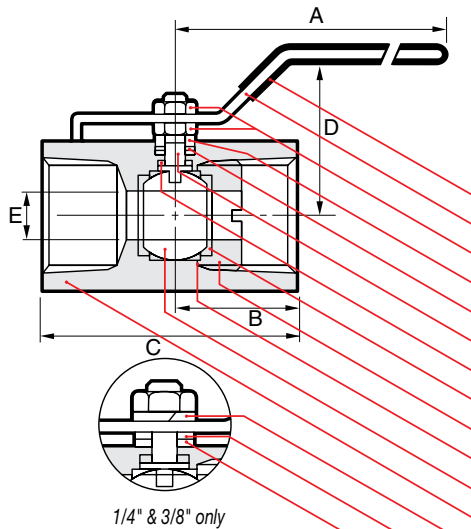

• Oval handles optionally available

NAME / MATERIAL

- Handle Grip / Vinyl
- Handle / Carbon Steel Plated
- Handle Nut / Carbon Steel Plated
- Packing Bushing / Stainless Steel A276 Type 304
- Packing / PTFE
- Stem / Stainless Steel A276 Type 316
- Thrust Washer / Reinforced Teflon 15% GFT
- Seat / Reinforced Teflon 15% GFT
- Seat Retainer / Carbon Steel A108 GR 1020
- Gasket / PTFE
- Ball / Stainless Steel A351 CF8M (316)
- Body / Carbon Steel A108 GR.1020 (A105N on 2")
- Stem Washer / Stainless Steel A276 Type 304
- Belleville Washer / Stainless Steel 301
- Spring Washer / Stainless Steel A276 Type 304

D I M E N S I O N S								
size	8	10	15	20	25	32	40	50
mm/in	1/4	3/8	1/2	3/4	1	1 1/4	1 1/2	2
A	71.0	85.5	109.47	112.5	112.5	147.50	147.50	154.00
mm/in	2.8	3.4	4.31	4.43	4.43	5.81	5.81	6.06
B	23.90	26.05	32.95	37.25	44.50	48.60	52.55	57.70
mm/in	0.94	1.03	1.30	1.47	1.75	1.91	2.07	2.27
C	43.10	47.35	61.72	69.85	85.73	93.67	101.60	114.30
mm/in	1.70	1.86	2.43	2.75	3.38	3.69	4.00	4.50
D	29.1	33.35	54.41	59.15	62.15	68.00	69.00	81.90
mm/in	1.15	1.31	2.14	2.33	2.45	2.68	2.72	3.22
E	4.60	6.80	9.20	12.50	16.00	20.00	24.70	32.00
mm/in	0.18	0.27	0.36	0.49	0.63	0.79	0.97	1.26
CV	1.5	3.5	5.7	10	16	25	40	62
weights	0.078	0.120	0.315	0.460	0.690	1.360	1.590	2.700
kg/lb	0.172	0.264	0.693	1.012	1.518	2.992	3.498	5.940

