

F Series Flanged Carbon Steel Ball Valves

F-150-CS-F-SS-N

Full port, Two piece body
ANSI B16.34 Class 150
Blowout-proof stem
ISO 5211 Mounting pad
Floating Ball, Anti-static device
Fire-safe design
Comply to NACE MR-01-75-2002
& MR-01-03



3.3

Model F-150-LC-F-SS-N (LCC body) is available

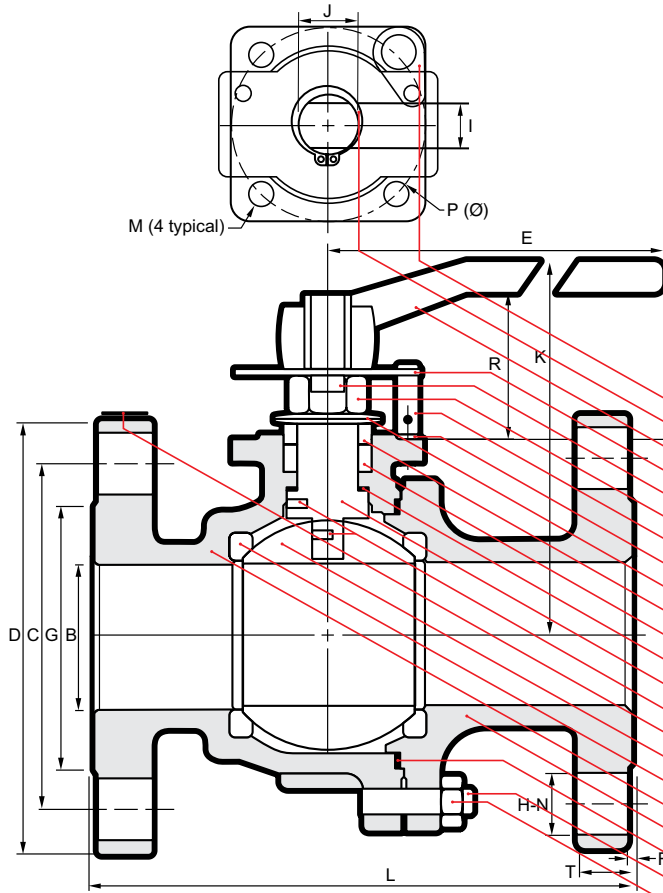

NAME / MATERIAL			
Model Code:	CS	LC	*FS
1. Lock Plate /	Stainless Steel A276 Type 304		
2. Retaining Ring /	Carbon Steel		
3. Handle /	Ductile Iron		
4. Stopper Plate /	Stainless Steel A276 Type 304		
5. Lock Washer /	Stainless Steel A276 Type 304		
6. Gland Nut /	Carbon Steel		
7. Stopper Pin /	Stainless Steel A276 Type 304		
8. Lock Washer /	Stainless Steel A276 Type 304		
9. Belleville Washer /	Stainless Steel 301		
10. Gland /	Stainless Steel A276 Type 304		
11. Packing /	PTFE		(Graphite)
12. Thrust Washer /	RPTFE 15% GFT		
13. Stem /	Stainless Steel A276 Type 316		
14. Anti-Static Device /	Stainless Steel A276 Type 304		
15. Identification Plate /	Stainless Steel A276 Type 304		
16. Ball /	Stainless Steel A351 - CF8M		
17. Seat /	PTFE (TFM-1600)		
18. Body /	Cast Steel A216-WCB	(LC: A352 LCC)	
19. Cap /	Cast Steel A216-WCB	(LC: A352 LCC)	
20. Body Seal /	PTFE		(Graphite)
21. Bolt Nut /	A194 Grade 2HM	(LC: A194 7M)	
22. Stud Bolt /	A193 Grade B7M	(LC FS: A320 Grade L7M)	

*Fire Safe Certified to API-607

FIG.	F-150-CS-F-SS-N	CLASS	150	SIZE	2	B16.34
SEAT	PTFE-S	BODY	WCB	TRIM	316	NACE
RATING	285 PSIG AT 100°F/200 PSIG AT 400° MAX					
CS - IDENTIFICATION PLATE						

FIG.	F-150-LC-F-SS-N	CLASS	150	SIZE	2	B16.34
SEAT	PTFE-S	BODY	LCC	TRIM	316	NACE
RATING	290 PSIG AT 100°F/200 PSIG AT 400° MAX					
LC - IDENTIFICATION PLATE						

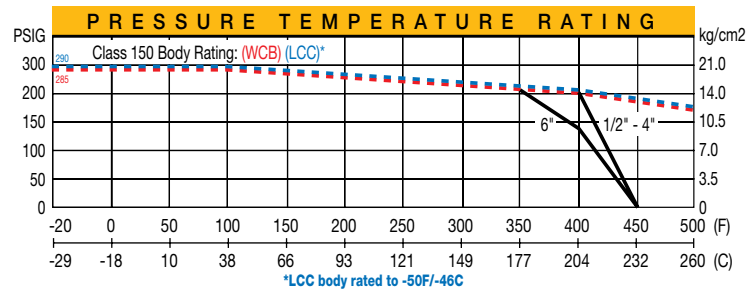
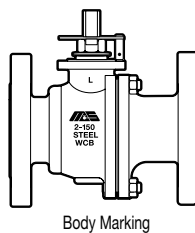

	D	B	C	I	D	E	M	F	G	H	I	J	K	L	S	I	O	N	S	ISO 5211 flange	kg/lb
1/2	15	60.5	89	130	1.6	35	16	8	11	83	108	1/4" UNC	4	36	11.2	27	F03	1.64			
	0.59	2.38	3.50	5.12	0.06	1.38	0.62	0.31	0.43	3.27	4.25			1.42	0.44	1.06		3.60			
3/4	19	70.0	98.5	130	1.6	43	16	8	11	86	117	1/4" UNC	4	36	11.2	27	F03	2.00			
	0.75	2.75	3.88	5.12	0.06	1.69	0.62	0.31	0.43	3.39	4.62			1.42	0.44	1.06		4.40			
1"	24	79.0	108	160	1.6	51	16	10	14	104	127	1/4" UNC	4	50	11.2	35.5	F05	3.15			
	0.95	3.12	4.25	6.30	0.06	2.00	0.62	0.39	0.55	4.09	5.00			1.97	0.44	1.40		6.93			
1 1/2	38	98.5	127	230	1.6	73	16	14	20	125	165	5/16" UNC	4	70	14.3	49	F07	6.26			
	1.50	3.88	5.00	9.06	0.06	2.88	0.62	0.55	0.79	4.92	6.50			2.76	0.56	1.93		13.77			
2"	50	120.5	152	230	1.6	92	19	14	20	134.5	178	5/16" UNC	4	70	15.9	49	F07	9.30			
	1.97	4.75	5.98	9.06	0.06	3.62	0.75	0.55	0.79	5.30	7.00			2.76	0.63	1.93		20.46			
2 1/2	65	139.7	178	400	1.6	104.6	19	17	25	170.5	190.5	3/8" UNC	4	102	17.5	61	F10	16.82			
	2.56	5.50	7.00	15.75	0.06	4.12	0.75	0.67	0.98	6.71	7.50			4.02	0.69	2.40		37.00			
3"	76	152.5	190	400	1.6	127	19	17	25	181.5	203	3/8" UNC	4	102	19.1	61	F10	22.00			
	3.00	6.00	7.48	15.75	0.06	5.00	0.75	0.67	0.98	7.15	8.00			4.02	0.75	2.40		48.40			
4"	100	190.5	229	460	1.6	157	19	23	34	205.5	229	1/2" UNC	8	125	23.9	73	F12	37.00			
	3.94	7.50	9.02	18.11	0.06	6.18	0.75	0.91	1.34	8.09	9.02			4.92	0.94	2.87		81.40			
6"	150	241.5	279	1000	1.6	216	22	27	40	289.5	394	5/8" UNC	8	140	25.4	90	F14	85.3			
	5.91	9.50	10.98	39.37	0.06	8.50	0.88	1.06	1.57	11.40	15.51			5.51	1.00	3.54		187.66			