Overview 20

Pressure Seal Gate Valves 21

Pressure Seal Globe
Valves “T-Pattern” 22

Pressure Seal Check Valves 23

Pressure Seal Globe
Valves “Y-Pattern” 24

PRESSURE SEAL VALVES



PRESSURE SEAL VALVES

Cast steel, outside screw and yoke, rising stem, non-rising handwheel, stellite welded seat rings, removable yoke sleeve.

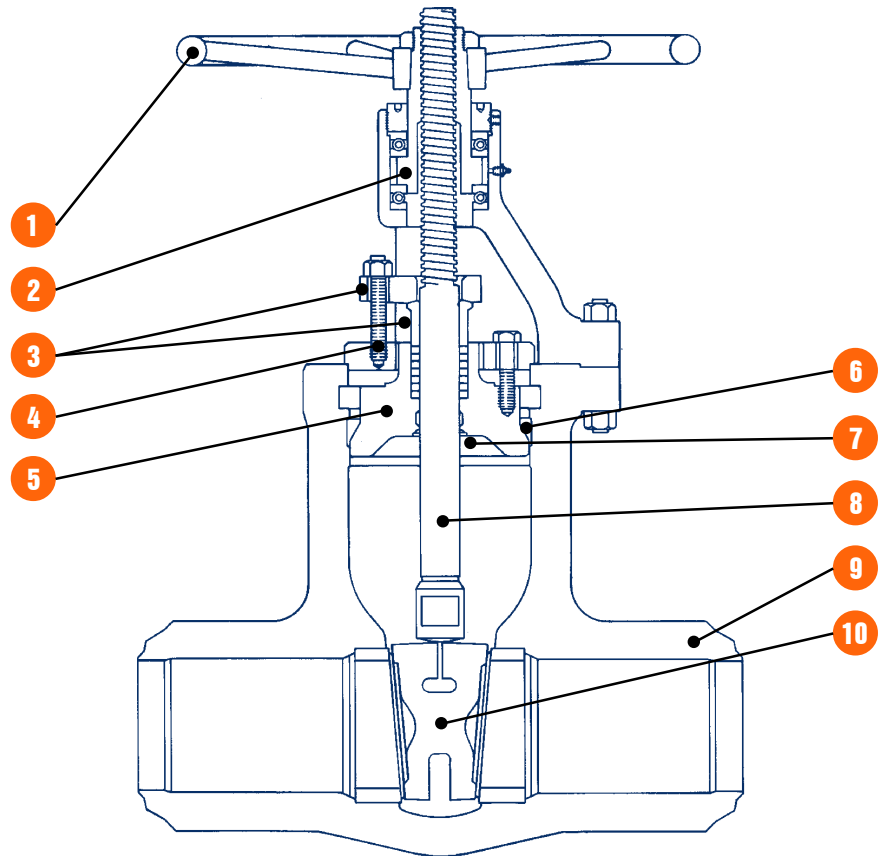

1. **HANDWHEEL.** The five-spoked handwheel is fabricated from steel pipe. The hub has a hexagonal taper for coupling to the yoke sleeve.
2. **YOKE SLEEVE.** The yoke sleeve is made from cast Iron Ni resist D2 having high resistance to wear and a high melting point, about 2000° F. It is designed to permit removal from the bonnet or the yoke while the valve is in service. Gate Valves 6" 600 lb. Class and above are fitted with ball thrust bearing.
3. **GLAND AND GLAND FLANGE.** They are forged steel and are supplied in two pieces. The contact surfaces between the gland and the flange have a spherical profile to permit the gland to descend parallel to the stem even if the eyebolts are unevenly tightened.
4. **GLAND BOLTS AND NUTS.** Gland studs are fastened to the bonnet flange. Remove gland nuts to allow repacking.
5. **BONNET.** The bonnet is in forged steel in sizes up to 5" and cast steel in sizes 6" and larger. It is cylinder shaped and in the center has a hole for guiding the stem and incorporates a stellite faced backseat and the stuffing box. A perfectly ground tapered seat is machined out of the lower outside diameter to mate with the seal ring. The upper outer diameter is threaded for a jacking nut up to 6" size. Larger sizes are provided with a jacking plate and screws.
6. **PRESSURE SEAL RING.** It is in silver-plated ARMCO Oron with a maximum hardness of 90 Brinell, carefully machined to provide a perfect tight seal.
7. **BACKSEAT.** It is integral with the bonnet and stellite faced and will provide a perfect tight seal between stem and bonnet.
8. **STEM.** The stem is in forged stainless steel and is part of the trim. The stem is provided with a T head. A ground backseat is provided to ensure a perfectly tight seal to the stuffing box when the valve is fully open. The stem is ground to minimize friction and prevent damage to gland packing. The threading is trapezoidal ACME type. Dimensions comply with the API 600 standard.
9. **BODY.** The body is in cast steel with a cylindrical bonnet area designed to withstand high pressures with minimum pressure drop. Wedge guides and stellite seat rings are welded with the body. The connection ends are normally of the butt welding type
10. **WEDGE.** The wedge is part of the trim. It is in cast alloy steel and supplied as the flexible type. The top of the wedge is provided with a T connection to the stem. The guides on each side of the wedge are machined. Special attention is given to the stellite faced seating surfaces which are ground and lapped.

600 LB.

900 LB.

1500 LB.

2500 LB.

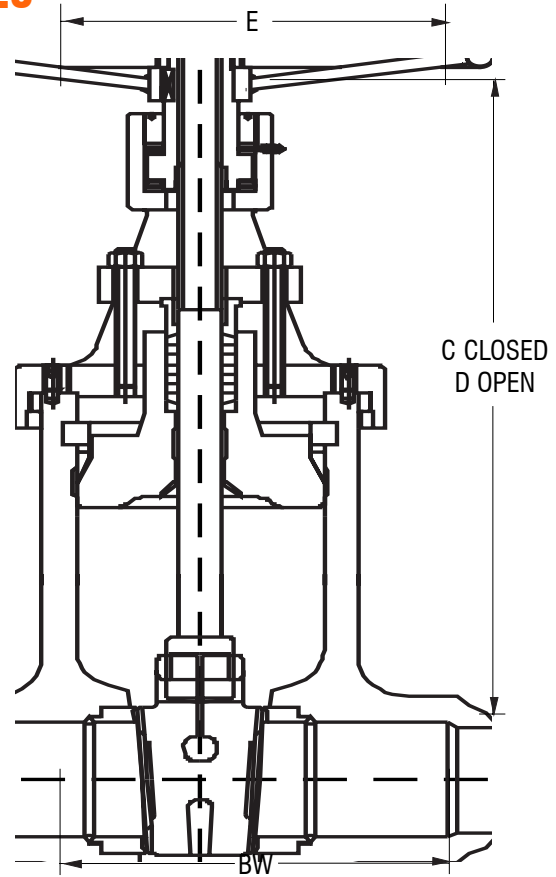

VALVE DIMENSIONS AND WEIGHTS

		2"	3"	4"	6"	8"	10"	12"	14"	16"	18"	20"	24"
600 LB.	End to End BW	11.5	14.0	17.0	22.0	26.0	31.0	33.0	35.0	39.0	43.0	47.0	55.0
	C - Closed	16.69	21.77	25.0	32.60	38.74	46.14	54.49	59.25	64.88	72.83	78.35	90.35
	D - Open	19.29	25.39	29.92	39.37	47.44	56.89	67.32	73.42	80.71	90.55	98.03	113.8
	E	10.0	12.0	14.0	20.0	22.0	27.0	27.0	30.0	35.0	35.0	35.0	43.31
	WEIGHTS BW	-	77.16	213.8	293.2	533.5	939.2	1642	-	-	-	-	-
		2"	3"	4"	6"	8"	10"	12"	14"	16"	18"		
900 LB.	End to End BW	14.5	12.0	14.0	20.0	26.0	31.0	36.0	39.0	43.0	48.0		
	C - Closed	16.4	23.62	26.10	33.07	41.53	53.15	55.12	51.42	67.72	81.89		
	D - Open	18.7	27.16	30.90	39.57	50.0	64.17	67.72	79.20	83.46	100.0		
	E	12.0	14.0	16.0	22.0	27.0	27.0	30.0	35.0	35.0	43.31		
	WEIGHTS BW	-	165.3	260.1	515.9	948.0	1803	-	-	-	-		
		2"	3"	4"	6"	8"	10"	12"	14"	16"			
1500 LB.	End to End BW	8.50	12.0	16.0	22.0	28.0	34.0	39.0	42.0	47.0			
	C - Closed	20.67	25.20	28.54	35.04	46.06	51.97	65.35	67.32	70.87			
	D - Open	23.23	28.74	33.27	41.34	55.12	63.0	77.56	80.31	85.83			
	E	12.0	16.0	18.0	22.0	27.0	35.0	43.31	43.31	43.31			
	WEIGHTS BW	92.59	191.8	321.9	696.7	1323	2359	-	-	-			
		2"	3"	4"	6"	8"	10"	12"					
2500 LB.	End to End BW	11.0	14.50	18.0	24.0	30.0	36.0	41.0					
	C - Closed	26.57	25.59	35.63	39.76	55.39	66.93	75.79					
	D - Open	28.35	28.35	39.17	45.08	62.40	75.79	86.22					
	E	12.0	16.0	18.0	22.0	27.0	35.04	43.31					
	WEIGHTS BW	134.5	-	-	-	-	4621	5688					

Materials and trim specifications Page 60
 All dimensions are in inches, all weights are in pounds.

End to end dimensions are per ANSI/ASME B16.10 where applicable.



PRESSURE SEAL GLOBE VALVES "T-PATTERN"

BONNEY FORGE

600 LB.

900 LB.

1500 LB.

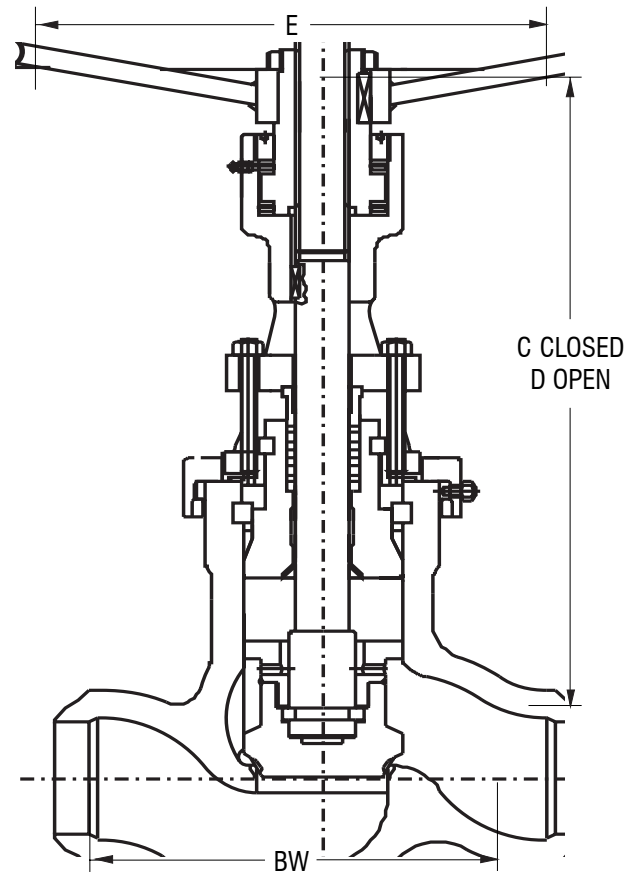

VALVE DIMENSIONS AND WEIGHTS

		2"	3"	4"	6"	8"	10"	12"
600 LB.	End to End BW	11.5	14.0	17.0	22.0	26.0	31.0	33.0
	C - Closed	14.4	21.9	26.6	33.3	40.9	46.1	55.1
	D - Open	15.9	23.7	29.1	37.2	47.6	57.9	58.3
	E	8.0	16.0	19.8	27.0	30.0	30.0	36.0
	WEIGHTS BW	-	44.09	-	147.7	277.8	-	723.1
		2"	3"	4"	6"	8"	10"	12"
900 LB.	End to End BW	14.5	15.0	18.0	24.0	29.0	33.0	38.0
	C - Closed	16.9	22.4	26.6	35.2	41.7	46.9	55.9
	D - Open	18.4	24.4	29.1	39.0	48.4	58.7	59.1
	E	12.0	19.8	19.8	27.0	30.0	30.0	36.0
	WEIGHTS BW	-	134.5	229.3	-	-	-	-
		2"	3"	4"	6"	8"	10"	12"
1500 LB.	End to End BW	14.5	18.5	21.5	27.75	32.75	39.0	44.5
	C - Closed	16.9	22.4	26.6	35.2	41.7	46.9	55.9
	D - Open	18.4	24.4	29.1	35.4	50.8	57.1	65.0
	E	12.0	19.8	19.8	19.8	30.0	36.0	36.0
	WEIGHTS BW	-	68.34	207.2	-	-	-	-

Materials and trim specifications Page 60
All dimensions are in inches, all weights are in pounds.

End to end dimensions are per ANSI/ASME B16.10 where applicable.

600 LB.

900 LB.

1500 LB.

2500 LB.

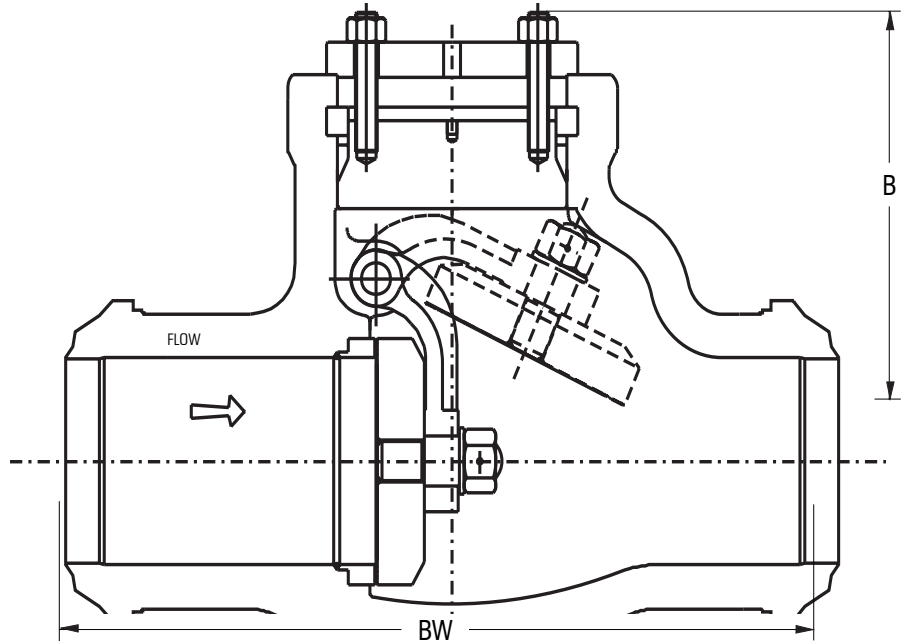

VALVE DIMENSIONS AND WEIGHTS

		2"	3"	4"	6"	8"	10"	12"	14"	16"			
600 LB.	End to End BW	11.5	14.0	17.0	22.0	26.0	31.0	33.0	35.0	39.0			
	B - Center to Top	6.7	6.9	8.5	9.3	11.3	13.4	15.6	17.7	19.3			
WEIGHTS	BW	-	44.09	-	147.7	277.8	-	723.1	-	-			
		2"	3"	4"	6"	8"	10"	12"	14"	16"	18"	20"	24"
900 LB.	End to End BW	14.5	12.0	14.0	20.0	26.0	31.0	36.0	39.0	43.0	48.0	52.0	61.0
	B - Center to Top	6.9	9.64	12.4	16.93	18.7	19.96	24.01	26.38	29.13	31.89	34.64	40.16
WEIGHTS	BW	97.00	-	-	-	-	-	-	-	-	-	-	-
		2"	3"	4"	6"	8"	10"	12"	14"	16"	18"	20"	24"
1500 LB.	End to End BW	14.5	18.5	21.5	22.0	28.0	34.0	39.0	42.0	47.0	60.25	65.5	76.5
	B - Center to Top	9.64	12.05	14.17	19.29	21.65	24.41	27.36	29.53	32.68	35.83	37.79	43.31
WEIGHTS	BW	-	68.34	207.2	-	-	-	-	-	-	-	-	-
		3"	4"	6"	8"	10"	12"						
2500 LB.	End to End BW	14.50	18.0	24.0	30.0	36.0	41.0						
	B - Center to Top	12.05	14.17	19.29	21.65	24.41	27.36						
WEIGHTS	BW	-	-	-	-	-	-						

Materials and trim specifications Page 60
 All dimensions are in inches, all weights are in pounds.

End to end dimensions are per ANSI/ASME B16.10 where applicable.



PRESSURE SEAL GLOBE VALVES "Y-PATTERN"

BONNEY FORGE

900 LB.

1500 LB.

2500 LB.

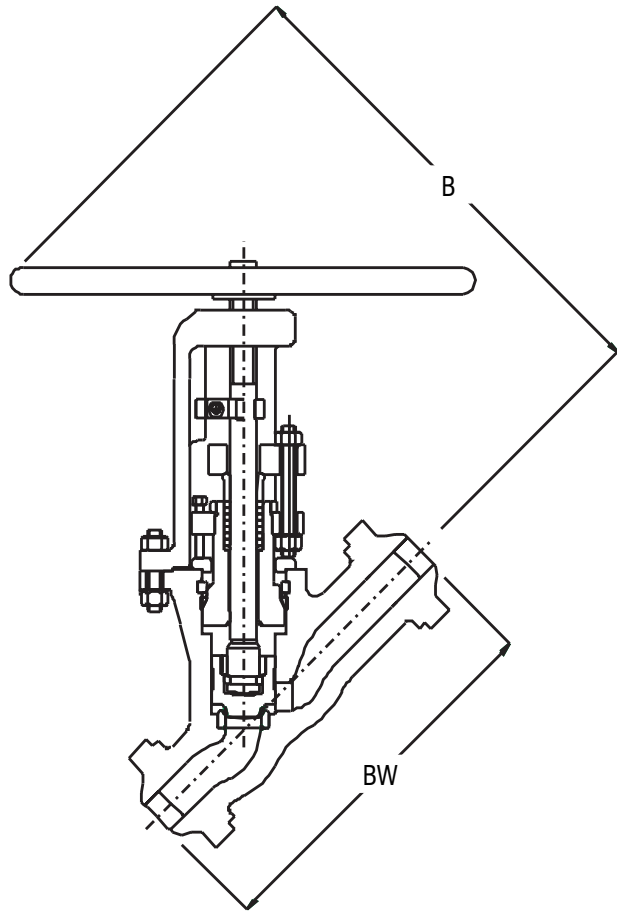

VALVE DIMENSIONS AND WEIGHTS

		3"	4"	6"	8"	10"	12"	14"				
900 LB.	End to End BW	15.0	18.0	24.0	29.0	33.0	38.0	40.5				
	B - Center to Top	19.68	19.68	43.31	51.18	51.18	82.68	82.68				
WEIGHTS	BW	-	-	-	-	-	-	-				
		2"	2.5"	3"	4"	6"	8"	10"	12"	14"	16"	18"
1500 LB.	End to End BW	14.5	16.50	18.50	21.50	27.75	32.75	39.0	44.50	49.50	54.5	60.50
	B - Center to Top	19.68	19.68	23.62	31.50	51.81	82.68	82.68	82.68	82.68	82.68	82.68
WEIGHTS	BW	-	-	-	-	-	-	-	-	-	-	-
		2"	3"	4"	6"	8"	10"	12"				
2500 LB.	End to End BW	17.75	22.75	26.50	36.0	40.25	50.0	56.0				
	B - Center to Top	23.62	31.50	82.68	82.68	82.68	82.68	82.68				
WEIGHTS	BW	-	-	-	-	-	-	-				

Materials and trim specifications Page 60
All dimensions are in inches, all weights are in pounds.

End to end dimensions are per ANSI/ASME B16.10 where applicable.