

# CAST 316 STAINLESS STEEL VALVES

FIG. 90B-200 SWING CHECK VALVE (CF8M)

FIG. 91B-200 WEDGE GATE VALVE (CF8M)

FIG. 92B-200 GLOBE VALVE (CF8M)



## Design Features

- 200 WOG/120 WSP @ 350°F Rated
- Investment Cast
- Compact Design

*An economical choice to handle a variety of corrosive fluids.*



# CAST 316 STAINLESS STEEL VALVES

PRESSURE TEMPERATURE RATING 200 WOG/120 WSP @ 350°F

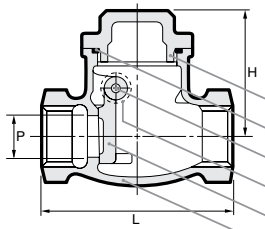
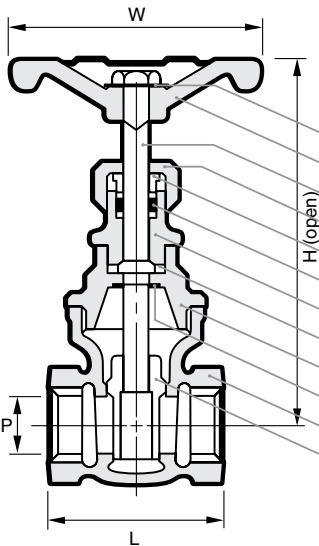

**FIG. 90B-200 N.P.T. or FIG. 90BSW Socket Weld**

**PARTS / MATERIAL**

1. Cap / CF8M
2. Gasket / PTFE
3. Hinge Pin / 316
4. Plug / 316
5. Disc / CF8M
6. Body / CF8M

		DIMENSIONS							
		1/2	3/4	1	1 1/4	1 1/2	2	2 1/2	3
Valve in/mm		15	20	25	32	40	50	65	75
	L	2.60	3.18	3.58	4.19	4.75	5.50	7.06	7.89
in/mm		66	81	91	106.5	121	141	160	190
	H	1.81	2.13	2.36	2.76	2.95	3.23	3.58	3.94
in/mm		46	54	60	70	75	82	91	100
	P	0.59	0.79	0.98	1.22	1.46	1.89	2.48	2.95
in/mm		15	20	25	31	37	48	63	75
	lbs/kg	0.66	1.06	1.65	2.53	3.40	5.60	8.38	13.01
		0.30	0.48	0.75	1.15	1.54	2.54	3.80	5.90

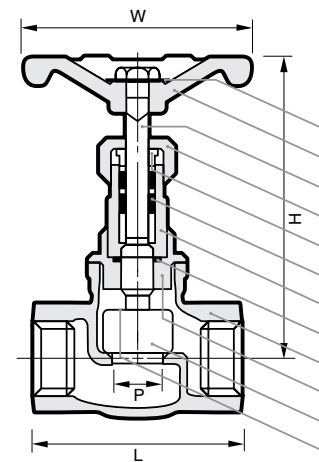

**FIG. 91B-200 N.P.T. Only (Non-Rising Stem)**

**PARTS / MATERIAL**

1. Name Plate / Aluminum
2. Handwheel / FCD
3. Stem / 316
4. Packing Nut / CF8
5. Gland / CF8M
6. Gland Packing / PTFE
7. Packing Box / 316
8. Stem Washer / 316
9. Bonnet / CF8M
10. Snap Ring / 316
11. Body / CF8M
12. Disc / CF8M

		DIMENSIONS					
		1/2	3/4	1	1 1/4	1 1/2	2
Valve in/mm		15	20	25	32	40	50
	L	2.24	2.38	2.64	2.99	3.43	3.70
in/mm		57	60.5	67	76	87	94
	H	3.98	4.25	4.65	5.08	6.81	7.40
in/mm		101	108	118	129	173	186
	W	2.44	2.44	2.87	2.87	3.74	4.61
in/mm		62	62	73	73	95	117
	P	0.63	0.80	0.98	1.25	1.48	1.90
in/mm		16.1	20.3	25.0	31.8	37.5	48.3
	lbs/kg	1.15	1.39	1.79	2.60	4.41	6.22
		0.52	0.63	0.81	1.18	2.00	2.82



**FIG. 92B-200 N.P.T. Only (Rising Stem)**

**NAME / MATERIAL**

1. Name Plate / Aluminum
2. Handwheel / FCD
3. Stem / 316
4. Packing Nut / CF8M
5. Gland / CF8M
6. Gland Packing / PTFE
7. Packing Box / 316
8. Stem Washer / 316
9. Body / CF8M
10. Bonnet / CF8M
11. Disc / 316
12. Snap Ring / 316

		DIMENSIONS					
		1/2	3/4	1	1 1/4	1 1/2	2
Valve in/mm		15	20	25	32	40	50
	L	2.60	2.70	3.08	3.39	3.86	4.35
in/mm		66	68.5	78.3	86	98	110.5
	H open	4.02	3.98	4.09	4.72	5.59	6.18
in/mm		102	101	104	120	142	157
	H close	3.78	3.66	3.74	4.41	4.88	5.43
in/mm		96	93	95	112	124	138
	W	2.44	2.44	2.87	3.74	3.74	4.61
in/mm		62	62	73	95	95	117
	P	0.59	0.63	0.75	0.94	1.26	1.50
in/mm		15	16	19	24	32	38
	lbs/kg	0.88	0.99	1.37	2.31	3.09	4.63
		0.40	0.45	0.62	1.05	1.40	2.10